

# 80-G10-2699-10 BLADE BLOCK (GS-1000)

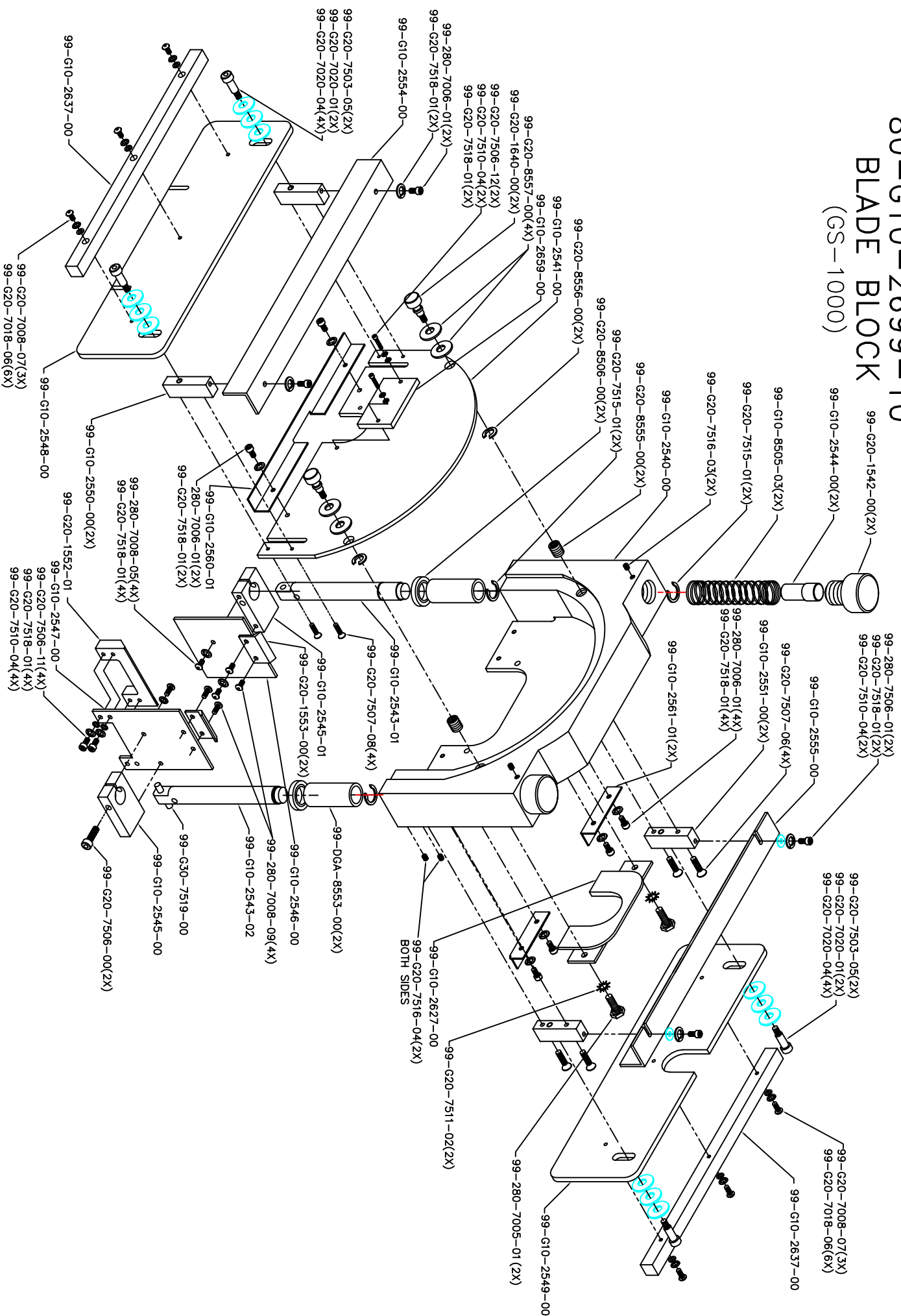

## BLADE BLOCK 80-G10-2699-10

PART #	DESCRIPTION	QTY
99-280-7005-01	1/4-20 X 3/8 H.H. CAD PLATED GR. 8	2
99-280-7006-01	10-32 X 3/8 N.F. SHC SST'	8
99-280-7008-05	10-32 X 3/8 BHS SST	4
99-280-7008-07	8-32 X 3/8 BHS SST	6
99-280-7008-09	10-32 X 1/4 BHS SST	4
99-DGA-8553-00	BUSHING, 3/4 X 1 X 1 1/2	2
99-G10-2540-00	BLADE BLOCK	1
99-G10-2541-00	COVER, BLADE	1
99-G10-2543-01	ROD, BLADE BLOCK (REAR)	1
99-G10-2543-02	ROD, BLADE BLOCK (FRONT)	1
99-G10-2544-00	ROD, SPRING GUIDE	2
99-G10-2545-00	CLAMP, FRONT ROD	1
99-G10-2545-01	CLAMP, REAR ROD	1
99-G10-2546-00	PLATE, REAR DIVERTER	1
99-G10-2547-00	PLATE, FRONT DIVERTER	1
99-G10-2548-00	LEXAN, OUTER DIVERTER	1
99-G10-2549-00	LEXAN, INNER DIVERTER	1
99-G10-2550-00	BLOCK, OUTER DIVERTER MOUNT	2
99-G10-2551-00	BLOCK, INNER DIVERTER MOUNT	2
99-G10-2554-00	ANGLE, OUTER BRACKET	1
99-G10-2555-00	ANGLE, INNER BRACKET	1
99-G10-2560-01	ANGLE, SMALL OUTER DIVERTER	1
99-G10-2561-01	ANGLE, SMALL INNER DIVERTER	2
99-G10-2627-00	INSERT, BLADE BLOCK	1
99-G10-2637-00	LEXAN, STIFFNER PANEL	2
99-G10-2659-00	EXTENSION, BLADE BLOCK COVER	1
99-G10-8505-03	SPRING, BLADE BLOCK	2
99-G20-1542-00	KNOB, BLADE BLOCK	2
99-G20-1552-01	BLOCK, FRONT DIVERTER	1
99-G20-1553-00	WIPER, STEEL	2
99-G20-1640-00	KNOB, BLADE COVER	2
99-G20-7018-06	LOCK WASHER, # 8 SPLIT SST	12
99-G20-7020-01	FLAT WASHER, STL TRA613	4
99-G20-7020-04	FLAT WASHER, .750 X .375 X .031	8
99-G20-7503-05	3/8 X 3/8 SHSB BLK STEEL	4
99-G20-7506-00	1/4-20 X 1 1/2 SHCS BLK STEEL	2
99-G20-7506-11	10-32 X 1/2 SHCS SST	6
99-G20-7506-12	10-32 X 5/8 SHCS	2
99-G20-7507-05	10-32 X 1/2 FHS SST	4
99-G20-7507-06	10-32 X 1 FHS SST	4
99-G20-7510-04	FLAT WASHER, # 10 SST	8
99-G20-7511-02	LOCK WASHER, 1/4 EXT TOOTH	2
99-G20-7515-01	SNAP RING 3/4" CRESENT	4
99-G20-7516-03	SET SCREW 1/4-20 X 3/8 SHCS SST	2
99-G20-7516-04	SET SCREW, 1/4-20 X 1/2 BLACK CONE	4
99-G20-7518-01	LOCK WASHER, # 10 SPLIT SST	20
99-G20-8506-00	SEAL, DUST	2
99-G20-8507-01	PIN, SNAPPER 1/4 X 1 3/8	1
99-G20-8555-00	INSERT, THREADED SST	2
99-G20-8556-00	RETAING RING SST	2

**BLADE BLOCK**  
**80-G10-2699-10**

99-G20-8557-00	WASHER, BELLEVILLE SST	4
99-G30-7519-00	DOWEL PIN , PRECISION 1/4 X 1 1/4	1