

84-G30-3699-00 MAIN FRAME (GX-3000)

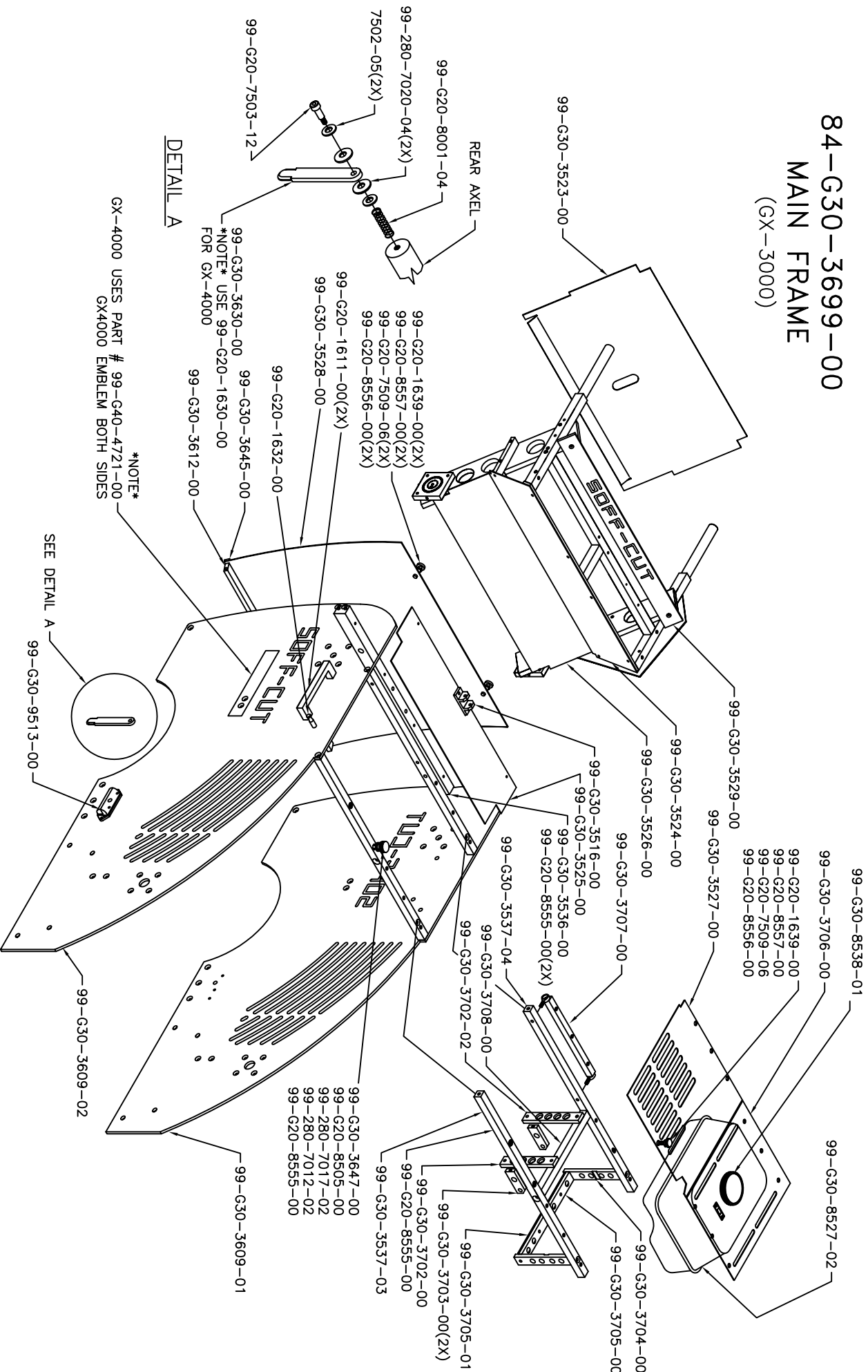

REAR AXEL

SOFF-CUT

SOFF-CUT

SOFF-CUT

DETAIL A

GX-4000 USES PART # 99-G40-4721-00
GX4000 EMBLEM BOTH SIDES

NOTE

SEE DETAIL A

- 99-G20-8001-04
- 99-280-7020-04(2X)
- 7502-05(2X)
- 99-G20-7503-12

- 99-G20-1639-00(2X)
- 99-G20-8557-00(2X)
- 99-G20-7509-06(2X)
- 99-G20-8556-00(2X)
- 99-G20-1611-00(2X)
- 99-G30-3528-00
- 99-G20-1632-00
- 99-G30-3645-00
- 99-G30-1630-00
- 99-G30-3612-00

- 99-G30-3529-00
- 99-G30-3524-00
- 99-G30-3526-00
- 99-G30-3707-00
- 99-G30-3516-00
- 99-G30-3525-00
- 99-G30-3536-00
- 99-G20-8555-00(2X)
- 99-G30-3537-04
- 99-G30-3708-00
- 99-G30-3702-02

- 99-G30-3609-02
- 99-G30-3647-00
- 99-G20-8505-00
- 99-280-7017-02
- 99-280-7012-02
- 99-G20-8555-00
- 99-G30-3609-01
- 99-G30-3537-03
- 99-G30-3702-00
- 99-G20-8555-00
- 99-G30-3703-00(2X)
- 99-G30-3705-01
- 99-G30-3704-00
- 99-G30-3705-00

- 99-G30-8538-01
- 99-G30-3706-00
- 99-G20-1639-00
- 99-G20-8557-00
- 99-G20-7509-06
- 99-G20-8556-00
- 99-G30-8527-02

- 99-G30-3609-02
- 99-G30-3647-00
- 99-G20-8505-00
- 99-280-7017-02
- 99-280-7012-02
- 99-G20-8555-00
- 99-G30-3609-01
- 99-G30-3537-03
- 99-G30-3702-00
- 99-G20-8555-00
- 99-G30-3703-00(2X)
- 99-G30-3705-01
- 99-G30-3704-00
- 99-G30-3705-00

MAIN FRAME

84-G30-3699-00

PART #	DESCRIPTION	QTY
99-280-7012-02	NUT, NYLOC 1/4-20	1
99-280-7017-02	FLAT WASHER, 1/4 SST.	1
99-280-7020-04	FLAT WASHER, .750 X .375 X .031	2
99-G20-1611-00	HANDLE	2
99-G20-1632-00	STOP, GUIDE ARM	1
99-G20-1639-00	KNOB, REAR PANEL	3
99-G20-7502-05	FLAT WASHER, .625 X .312 X .032 SST	2
99-G20-7503-12	SHSB, 5/16 X 1	1
99-G20-7509-06	LOCK WASHER, RIBBED (REAR ACCESS)	3
99-G20-8001-04	SPRING, REAR GUIDE	1
99-G20-8505-00	SPRING, #520 HOOD KNOB	1
99-G20-8555-00	THREADED INSERT SST.	4
99-G20-8556-00	RETAINING CLIP	3
99-G20-8557-00	WASHER, BELLEVILLE	3
99-G30-3516-00	BRACKET, HANDLE ACTUATOR	1
99-G30-3523-00	COVER, HANDLE ACTUATOR (TOP)	1
99-G30-3524-00	COVER, HANDLE FRONT (TOP)	1
99-G30-3525-00	COVER, HANDLE ACTUATOR (BOTTOM)	1
99-G30-3526-00	COVER, HANDLE FRONT (BOTTOM)	1
99-G30-3527-00	COVER, OIL ACCESS	1
99-G30-3528-00	PANEL, REAR ACCESS	1
99-G30-3529-00	PANEL, NAME PLATE	1
99-G30-3536-00	CROSS BAR, REAR ACCESS	1
99-G30-3537-03	SUPPORT BRACE HOOD KNOB	1
99-G30-3537-04	CROSSBAR, REAR TANK	1
99-G30-3609-01	SIDE PLATE, LEFT	1
99-G30-3609-02	SIDE PLATE, RIGHT	1
99-G30-3612-00	PIVOT, CROSS BAR (REAR)	1
99-G30-3630-00	GUIDE ARM, REAR	1
99-G30-3645-00	BRACE, BACK PANEL	1
99-G30-3647-00	KNOB, HOOD	1
99-G30-3702-00	SUPPORT, FUEL TANK (SHORT)	1
99-G30-3702-02	SUPPORT, FUEL TANK (LONG)	1
99-G30-3703-00	BRACKET, FUEL TANK (SHORT ANGLE)	2
99-G30-3704-00	BRACKET, FUEL TANK (NOTCHED)	2
99-G30-3705-00	STRAP, FUEL TANK (THICK)	1
99-G30-3705-01	BAR, ALUMINUM HEAT FOIL MOUNT (THIN)	1
99-G30-3706-00	COVER, FUEL TANK	1
99-G30-3707-00	BAR, INSPECTION COVER PIVOT	1
99-G30-3708-00	BAR, SUPPORT .750 THICK	1
99-G30-8527-02	FUEL TANK	1
99-G30-8538-01	GAS CAP	1
99-G30-9513-00	LIGHT, SIDE	1