

84-G30-3699-05 PUMP IDLER PULLEY (GX-3000)

99-G20-7505-21 (2X)
99-280-7018-08 (2X)

99-G30-3586-00
CROSS BAR
REFERENCE

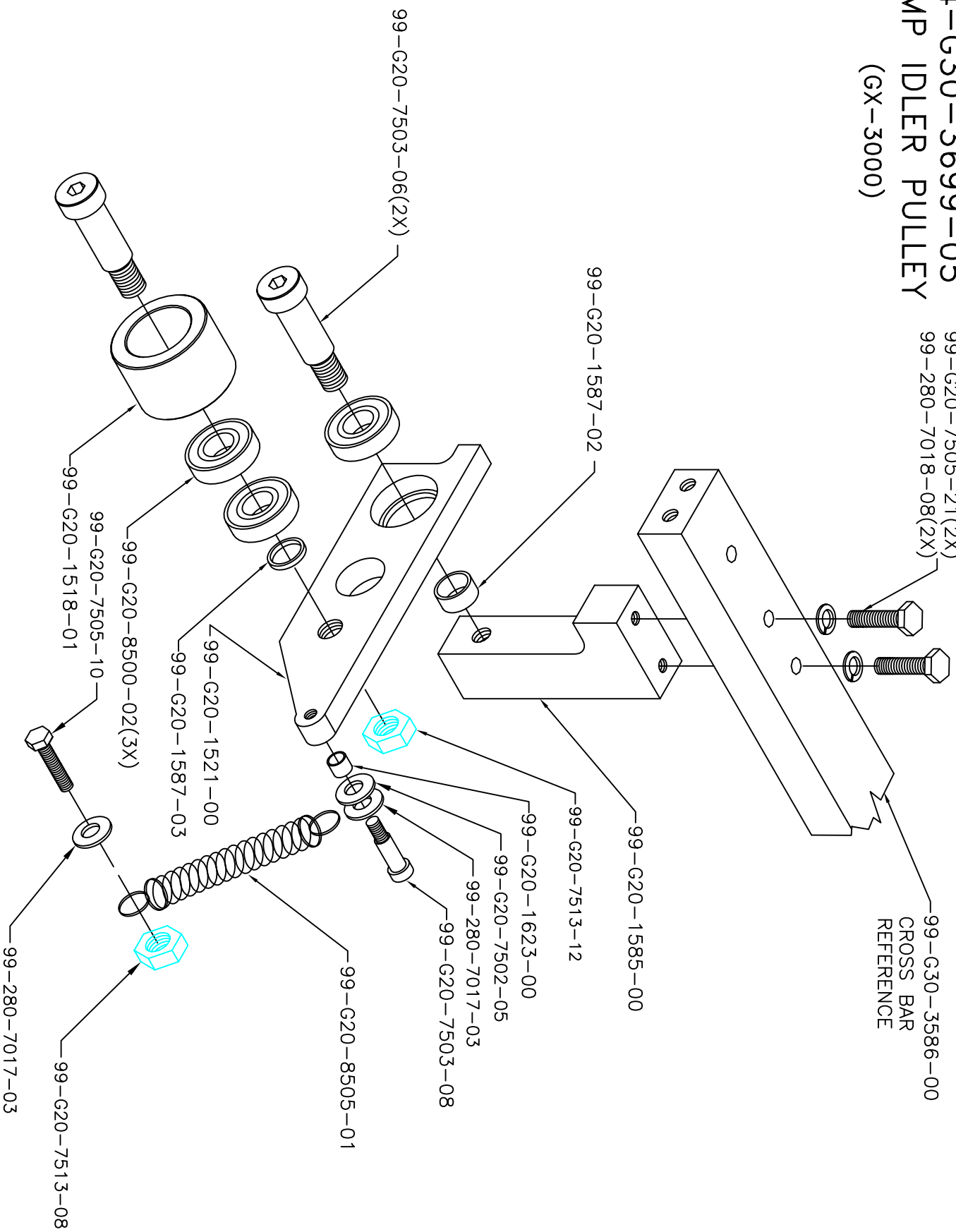

PUMP IDLER PULLEY

84-G30-3699-05

| PART # | DESCRIPTION | QTY |
|----------------|--------------------------------|-----|
| 99-280-7017-03 | FLAT WASER, 5/16 SEA GR 8 | 2 |
| 99-280-7018-08 | LOCK WASER, 5/16 SPLIT | 2 |
| 99-G20-1518-01 | PULLEY, FOR PUMP AND BLADE | 1 |
| 99-G20-1521-00 | ARM, PUMP IDLER PULLEY | 1 |
| 99-G20-1585-00 | BLOCK, PUMP IDLER PULLEY MOUNT | 1 |
| 99-G20-1587-02 | SPACER, ALUMINUM .350 WIDE | 1 |
| 99-G20-1587-03 | SPACER, ALUMINUM .100 WIDE | 1 |
| 99-G20-1623-00 | BUSHING, GUIDE ARM | 1 |
| 99-G20-7502-05 | WASHER, .625 X .312 X .032 SST | 1 |
| 99-G20-7503-06 | 5/8 3/4 BLACK STEEL SHSB | 2 |
| 99-G20-7503-08 | 5/16 X 3/4 BLACK STEEL SHSB | 1 |
| 99-G20-7505-10 | 5/16-24 X 1 1/2 H.H. | 1 |
| 99-G20-7505-21 | 5/16-18 X 1 3/4 H.H GR 8 | 2 |
| 99-G20-7513-08 | 5/16-24 JAM NUT ZINC | 1 |
| 99-G20-7513-12 | 1/2-13 JAM NUT | 1 |
| 99-G20-8500-02 | BEARING, IDLER PULLEY R10LL | 3 |
| 99-G20-8505-01 | SPRING, PUMP IDLER PULLEY | 1 |