

84-G30-3699-07 HANDLE (GX-3000)

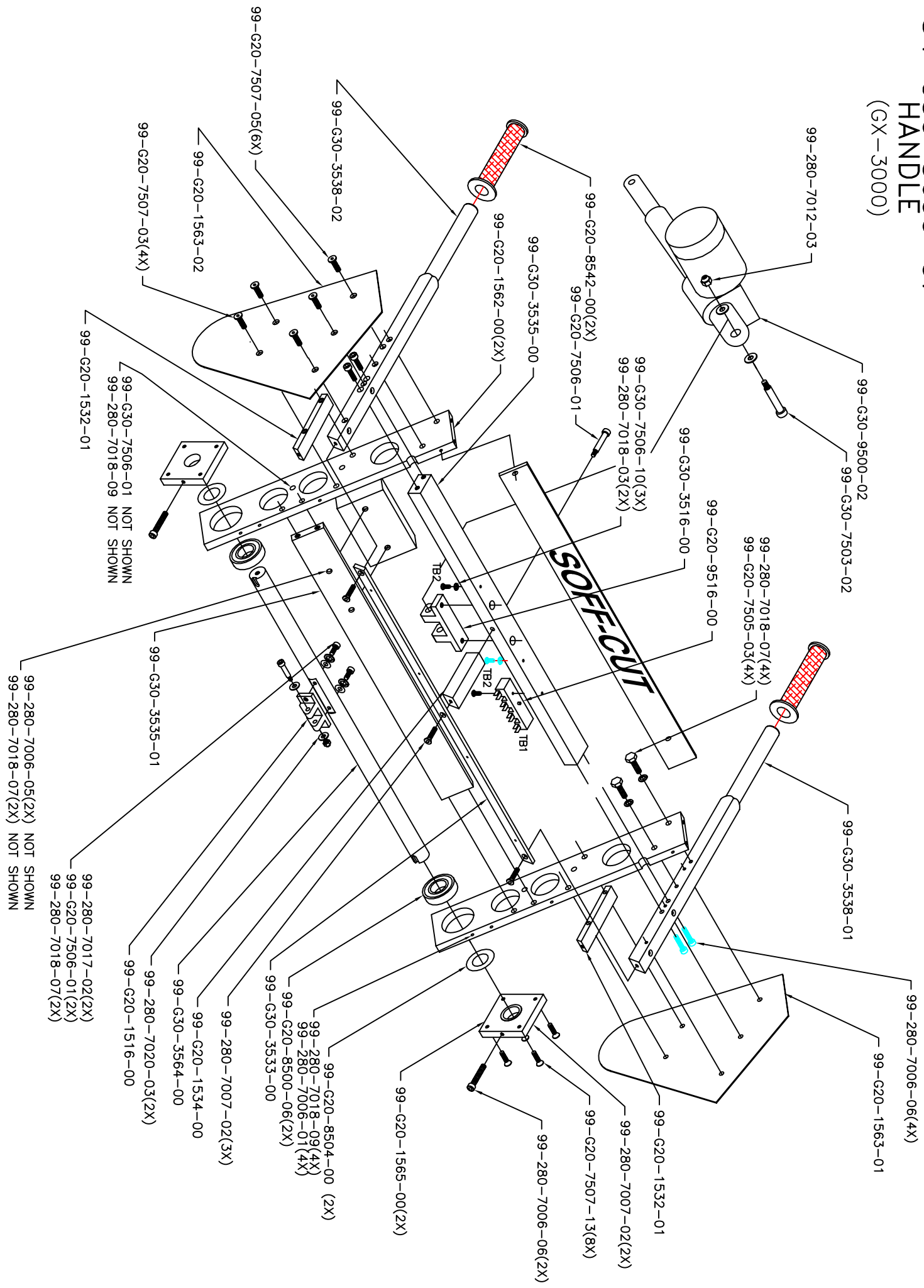

HANDLE

84-G30-3699-07

PART #	DESCRIPTION	QTY
99-280-7006-01	10-32 X 3/8 SHCS	4
99-280-7006-05	1/4-20 X 1 SHCS SST.	2
99-280-7006-06	1/4-20 X 1 1/4 SHCS SST	6
99-280-7007-02	1/4-20 X 3/4 FHS SST.	5
99-280-7012-03	5/16-18 CAD PL. NYLOC	1
99-280-7017-02	1/4" FLAT WASHER SST	2
99-280-7018-03	#8 INT. TOOTH LOCK WASHER	2
99-280-7018-07	1/4" SPLIT LOCK WASHER	8
99-280-7018-09	#10 SPLIT LOCK WASHER	5
99-280-7020-03	1/4" DELRIN FLAT WASHER	2
99-G20-1516-00	ANGLE, ACTUATOR BRACKET/HNDL/MN FRAME	1
99-G20-1532-01	SPACER, HANDLE BAR	2
99-G20-1534-00	BAR, SUPPORT (KEY DASH PANEL)	1
99-G20-1562-00	PLATE, HANDLE SUPPORT	2
99-G20-1563-01	COVER, HANDLE LEFT SIDE	1
99-G20-1563-02	COVER, HANDLE RIGHT SIDE	1
99-G20-1565-00	PLATE, HANDLE SHAFT SUPPORT	2
99-G20-7505-03	1/4-20 X 1 1/4 GR8 HEX SCREW	4
99-G20-7506-01	1/4-20 X 1 1/2 SST. SHCS	3
99-G20-7507-03	10-24 X 1 1/4 SST. FHS	4
99-G20-7507-05	10-32 X 1/2 SST. FHS	6
99-G20-7507-13	1/4-20 X 5/8 FHS	8
99-G20-8500-06	BEARING 10" WHEEL	2
99-G20-8504-00	SHIM, HANDLE SST.	2
99-G20-8542-00	GRIPS	2
99-G20-9510-02	PIN, FEMALE AMP	8
99-G20-9510-04	CONN 1 PIN CAP	8
99-G20-9511-03	WIRE 18 AWG RED	1
99-G20-9511-04	WIRE 18 AWG GREEN	4
99-G20-9516-00	TERMINAL BLOCK (G2000)	1
99-G20-9522-00	RING TOUNG NYLON	1
99-G20-9522-01	RING TOUNG NYLON W/INS GR	9
99-G30-3516-00	BRACKET, HANDLE ACTUATOR	1
99-G30-3533-00	CROSS BAR, (KEY DASH)	1
99-G30-3535-00	CROSS BAR, KEY DASH/A	1
99-G30-3535-01	BRACE, SUPPORT (BOTTOM)	1
99-G30-3538-01	BAR, HANDLE (LEFT)	1
99-G30-3538-02	BAR, HANDLE (RIGHT)	1
99-G30-3564-00	SHAFT, HANDLE	1
99-G30-7503-02	3/8 X 2 1/4 SHSB	1
99-G30-7506-01	10-24 X 1/2 SHCS SST.	1
99-G30-7506-10	8-32 X 1/2 SST.	3
99-G30-9500-02	ACTUATOR, HANDLE 2-1/2" STROKE	1