

87-G42-3699-05 PUMP IDLER PULLEY (GX-4200)

99-G20-7505-21 (2X)
99-280-7018-08 (2X)

99-G30-3586-00
CROSS BAR
REFERENCE

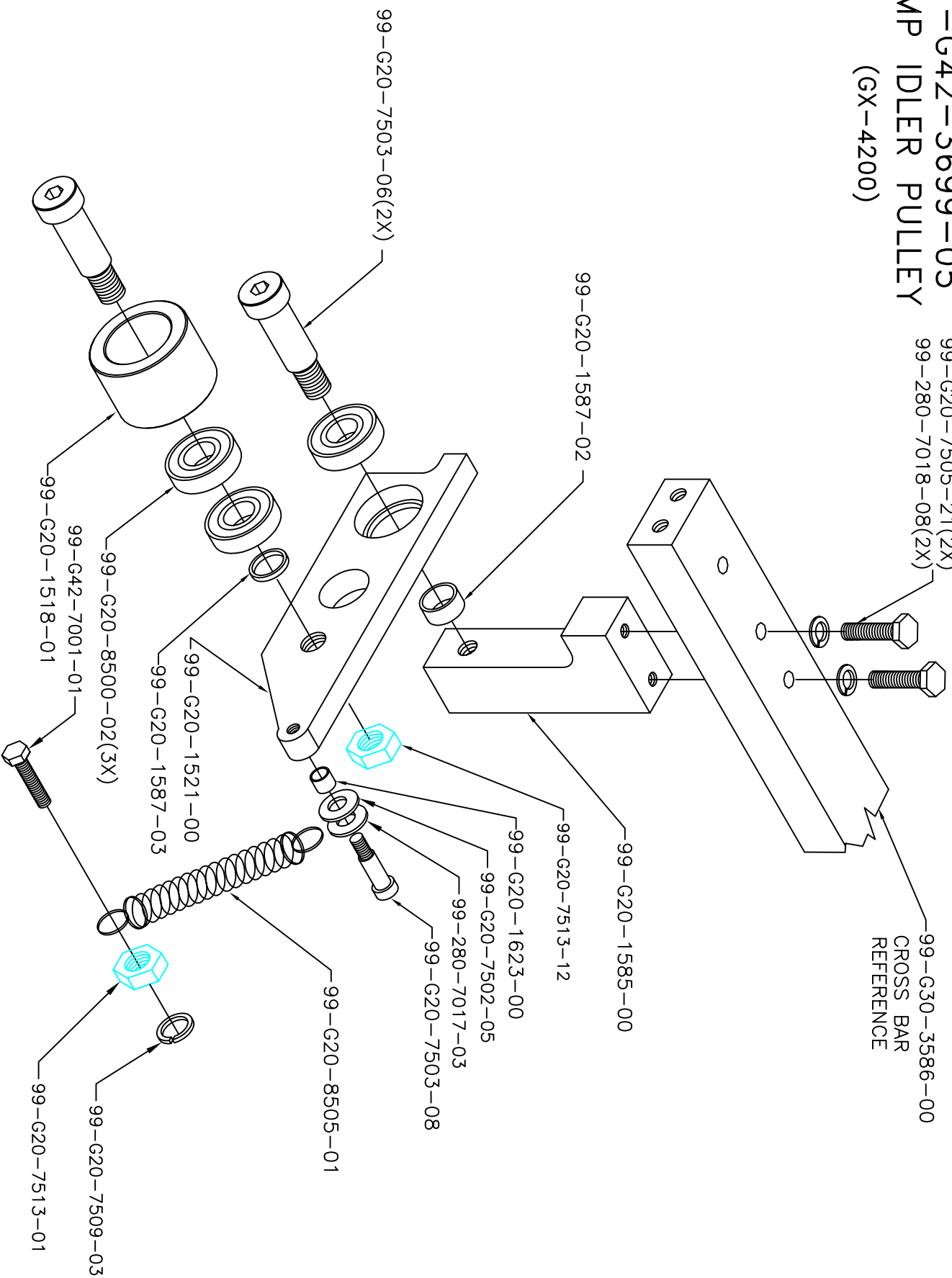

PUMP IDLER PULLEY

87-G42-3699-05

PART #	DESCRIPTION	QTY
99-280-7017-03	FLAT WASER, 5/16 SEA GR 8	2
99-280-7018-08	LOCK WASER, 5/16 SPLIT	2
99-G20-1518-01	PULLEY, FOR PUMP AND BLADE	1
99-G20-1521-00	ARM, PUMP IDLER PULLEY	1
99-G20-1585-00	BLOCK, PUMP IDLER PULLEY MOUNT	1
99-G20-1587-02	SPACER, ALUMINUM .350 WIDE	1
99-G20-1587-03	SPACER, ALUMINUM .100 WIDE	1
99-G20-1623-00	BUSHING, GUIDE ARM	1
99-G20-7502-05	WASHER, .625 X .312 X .032 SST	1
99-G20-7503-06	5/8 3/4 BLACK STEEL SHSB	2
99-G20-7503-08	5/16 X 3/4 BLACK STEEL SHSB	1
99-G20-7505-21	5/16-18 X 1 3/4 H.H GR 8	2
99-G20-7509-03	3/8 SPLIT WASHER	1
99-G20-7513-01	3/8-16 DOUBLE CHAM NUT	1
99-G20-7513-08	5/16-24 JAM NUT ZINC	1
99-G20-7513-12	1/2-13 JAM NUT	1
99-G20-8500-02	BEARING, IDLER PULLEY R10LL	3
99-G20-8505-01	SPRING, PUMP IDLER PULLEY	1
99-G42-7001-01	3/8-16 X 2 H.H.	1